



## Electric Grill INSTRUCTION MANUAL

Read this manual carefully before operation

Pictures in this manual are for reference only, the product in kind prevail.



Model:  
CGBBQ5S

This instruction manual contains important information  
& recommendations that we would ask you to comply  
With to obtain best results from your products.

**CG** CHAUDHARY®  
GROUP  
*Touching life everyday*

**COMPONENT:**

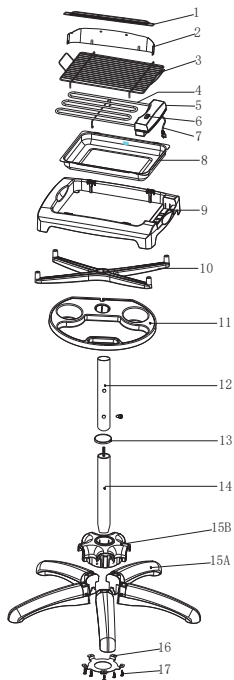

- 1 Rack
- 2 Baffle
- 3 Grill Net
- 4 Heater
- 5 Switch base
- 6 Control Switch
- 7 Power cord
- 8 Drip tray
- 9 Base
- 10 Bracket
- 11 Condiment tray
- 12 Upper stand tube
- 13 Decoration
- 14 Nether stand tube
- 15 A Stand foot
- 15 B Stand base
- 16 Washer
- 17 Screws

## INSTALLATION INSTRUCTIONS

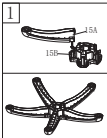

Install the stand feet (15A) into the stand base (15B) properly. That will be a "click" sound when the stand foot is fixed completely.

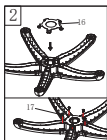

Place the washer (16) onto the stand base, and then install the screws (17) into the washer to fix the stand feet and stand base firmly.

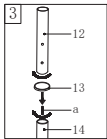

Install half of the threaded rod (a) in the nether tube (14). Put the decoration (13) on the nether tube (14) and assemble both tubes together; ensure that they are fixed well.

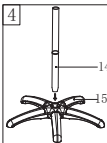

Connect the grill stand base (15) and the nether tube (14) together.

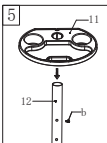

Set the Screw (b) to the corresponding hold, cross the Condiment tray(11) through the stand tube(12) , and it would on the screw (b)

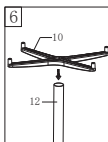

Set the bracket (10) on the Tube (12), then there would become a integrated grill. (The grill can be used with or without this stand).

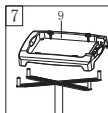

Put Base(9) on the grill stand and make sure to Set correct setting.(Making sure that the grill stand is placed on a dry flat)

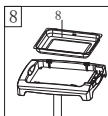

Drip tray(8) is for the correct place of the base.

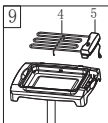

Slide and lock the element with its handle (5) into its position of grill base.



Place the grill net (3) on heat filter of the base(9)

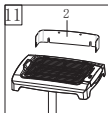

Make sure that the Baffle(2) is correct to settled in the gap of Grill Net (3)

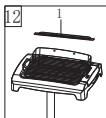

Set Rack (1) to the corresponding way of Baffle(2) and make sure not to slip off It

#### GENERAL SAFETY INSTRUCTIONS

- This device meets the safety requirements. Please read the instruction manual carefully before using the device. Please keep these instructions,
- By ignoring the safety instructions the manufacturer can not be hold responsible for the damage.
- This appliance is only to be used for household purposes and only for the purpose it is made for.
- This appliance is for household use only.
- Check if the voltage of the appliance corresponds to the main voltage of your home. Rated voltage: 220-240V~ 50Hz. The socket must be at least 16 A or 10 A slow-protected.
- The appliance should be switched off at mains when not in use.
- The appliance must be unplugged from the power supply after use and whilst any maintenance such as cleaning is carried out.
- This appliance is not intended to be used by persons (including children with reduced physical, sensory or mental capabilities, or lack of experience and knowledge, unless they have been given supervision or instructions concerning the use of the appliance by a person that is responsible for their safety.
- To protect children against the dangers of an electrical appliance, please make sure that you never leave the appliances unattended. There for you have to select a storage place for the appliance where children are not able to grab it. Make sure that the cable is not hanging in a downward position.
- The appliance must be placed on a stable, level and heat resistant surface.
- Do not place the appliance underneath or close to curtains, window coverings etc.
- Never use the device unsupervised.
- Do not use when the appliance is fallen, there are any signs of damage or when it leaks.
- Do not touch hot surfaces. Use handles or knobs.
- Do not use metal or sharp implements when cooking as these will damage the non-stick surface.
- Ensure there is sufficient ventilation around the appliance to allow the escape of heat and steam.

- Only cook consumable food.
- It is absolutely necessary to keep this appliance clean at all times because it comes into direct contact with food.
- Make sure the cord does not touch the hot parts of the appliance.
- Make sure that the cord is not hanging over the edge of the table or counter.
- Ensure that the supply cord is kept away from heat or sharp edges that could cause damage.
- Do not wind the cord around the appliance and do not bend it.
- In case an extension cable is necessary, it must be earthed, and its cross section must be at least 1.0 mm<sup>2</sup>. When using an extension cable, secure it safely so that people do not trip over it.
- Do not use this appliance with a damaged cord or plug or when the appliance has malfunctions, or has been damaged in any manner. To avoid a hazard make sure that a damaged cord or plug will be replaced by an authorized technician. Do not repair this appliance by yourself.
- All repairs should be made by a competent qualified electrician.
- To protect yourself against an electric shock, do not immerse the cord, plug or appliance in the water or any other liquid.
- This appliance is not intended to be operated by means of an external timer or separate remote-control system.
- Note: To avoid danger by accidental resetting the thermal protection, this appliance may not be powered through an external switching device, such as a timer, or connected to a circuit that regularly will be switched on or off.
- The use of accessory that is not recommended by the manufacturer can cause injuries and will invalidate any warranty that you may have.
- If handled properly and according to the instructions in this user manual, the appliance is safe to use based on scientific evidence available today.
- Never move the appliance by pulling the cord and make sure the cord can not become entangled.
- Unplug the appliance from the socket by changing the spare parts or for maintenance.
- Do not use this appliance near direct heat sources.
- Allow the device to cool down before you are going to remove or replace spare parts.
- We advise to place a heat resistant coating between your table and the appliance (this way you don't get burns on your table or table cloth).
- Be careful with oil and fat preparations because they might catch fire by overheating. Provide proper ventilation when using the appliance.
- Caution: Do not, under any circumstances, cover the grill rack with aluminium foil, barbecue dishes or other items, as the resulting build-up of heat could destroy the grill.

- Do not, under any circumstances, use charcoal or any other solid or liquid fuel to operate the grill.
- Allow the appliance to cool down before you clean or store it.
- Make sure that the appliance is stored in a dry environment.



#### **CAUTIONS:**

1. **Make sure the drip tray always with water to avoid overheating of the appliance, as well as make clean-up easier.**
2. **The grill surface will get very hot when cooking food. Care must be taken to avoid contact with surface.**
3. **The drip tray will be hot. Take care to avoid injury.**

#### **FIRST USE**

- Take the appliance and accessories out the box.
- Remove the stickers, protective foil or plastic from the device.
- Clean before the first use the grill with a wet cloth.
  - Check that the voltage of your appliance is the same as your mains
  - Before each use, unwind the flex completely. And move it two to four inches away from the wall. Remove any object that may have been on top of the unit.
  - Switch on at the mains
  - Pre-heating: 5-10 minutes.
  - By using the appliance for the first time, the raclettegrill may smell and emit some smoke. This is normal. The grease that may have adhered to the element during manufacture is burning off.

#### **USE**

- Make sure you place a heat resistance coating under the appliance in order to prevent traces due to heat and grease stains on your table.
- Put the stand onto a stable, flat surface.
- Fill the grease tray with water, and make sure the water level remains below the heating element (4).
- During the use, the water will evaporate and should be refilled.

**Note: Make sure you do not drip water onto the element.**

## **CLEANING AND MAINTENANCE**

- Unplug the appliance after use or if you want to clean it.
- Do not start cleaning the appliance before it is cooled down completely.
- Clean the inside of the grease tray with a paper towel or a soft cloth.
- Clean the outside of the appliance with a soft and slightly moistened cloth.
- Ensuring that there no moisture, oil or grease through the cooling slots seeps.
- Do not use a hard brush or other abrasive materials to clean the inside or the outside of the appliance, to prevent scratching the surface and the inside of the appliance.
- Do never immerse the appliance in water or any other liquid. Never use the dishwasher for cleaning the appliance.



**A Quality Product  
Of**



**IMPORTANT INFORMATION FOR CORRECT DISPOSAL OF THE PRODUCT  
IN ACCORDANCE WITH EC DIRECTIVE 2002/96/EC.**

At the end of its working life, the product must not be disposed of as urban waste.  
It must be taken to a special local authority differentiated waste collection centre or to a dealer providing this service.  
Disposing of a household appliance separately avoids possible negative consequences for the environment and health deriving from inappropriate disposal and enables the constituent materials to be recovered to obtain significant savings in energy and resources. As a reminder of the need to dispose of household appliances separately, the product is marked with a crossed-out wheeled dustbin.

Visit us at: [www.cginspiringlife.com](http://www.cginspiringlife.com)