

WATER DISPENSER INSTRUCTION MANUAL

Read this manual carefully before operation

Pictures in this manual are for reference only, the product in kind prevail.

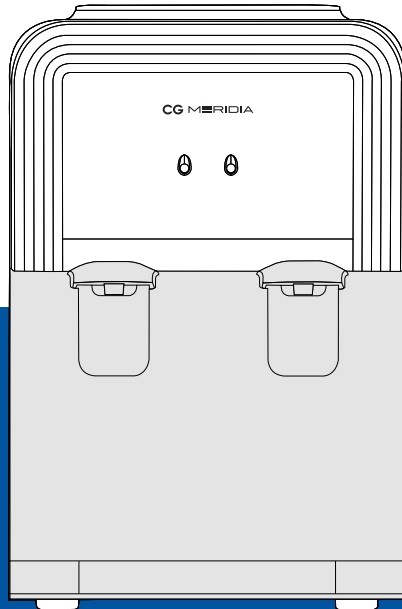

Model : CGMRTTHNM

This instruction manual contains important information & recommendations that we would ask you to comply with to obtain best results from your products.

General Remark

- The installation and maintenance has to be carried out by qualified professionals or authorized technicians.
- The manufacturer shall not be held responsible for any damage or malfunction caused by wrong installation or failing to comply with following instructions included in this pamphlet.
- For more detailed installation and maintenance guidelines, please refer to below chapters.

TABLE OF CONTENTS

<u>TITLE</u>	<u>PAGE</u>
1. SAFETY INSTRUCTIONS.....	(2)
2. FUNCTION INTRODUCTION.....	(2)
3. PART NAME.....	(3)
4. GETTING STARTED.....	(4)
5. CAUTION.....	(4)
6. TROUBLE SHOOTING.....	(6)
7. CLEANING.....	(6)
8. MACHINE INSTALLATION.....	(7)

1. SAFETY INSTRUCTIONS

1. This appliance is not intended for use by persons (including children) with reduced physical, sensory or mental capabilities, or lack of experience and knowledge, unless they have been given supervision or instruction concerning use of the appliance by a person responsible for their safety.
2. Children should be supervised to ensure that they do not play with the appliance.
3. This appliance is intended to be used in household and similar applications such as: staff kitchen areas in shops, offices and other working environments; farm houses and by clients in hotels, motels and other residential type environments; bed and breakfast type environments; catering and similar non-retail applications.
4. If the supply cord is damaged, it must be replaced by the manufacturer, its service agent or similarly qualified persons in order to avoid a hazard.
5. The appliance must not be cleaned by a water jet.
6. The appliance is suitable for indoor use only.
7. WARNING: Keep ventilation openings, in the appliance enclosure or in the built-in structure, clear of obstruction.
8. WARNING: Do not use mechanical devices or other means to accelerate the defrosting process, other than those recommended by the manufacturer.
9. The appliance must not be immersed.
10. This product is not recommended to use in areas above 1,500m altitude.
11. It is recommended to use bottled pure water. If you use hard water, may lead to hot pot furring or detonation tank or pipeline risk. If you need cleaning tube, remove scale, need to find a professional institutions and professional operation.
12. Rated voltage: 220-240V~ 50/60Hz.
13. WARNING: When positioning the appliance, ensure the supply cord is not trapped or damaged.
14. WARNING: Do not locate multiple portable socket-outlets or portable power supplies at the rear of the appliance.

2. FUNCTION INTRODUCTION

1. This machine is reliable for its safety & durability.
2. This machine can satisfy the need of tea & coffee. It must be used indoor only. With adoption of distinctive thermal isolation technology, this machine can minimize thermal exchange between hot & normal water.
3. Do not store explosive substances such as aerosol cans with a flammable propellant in this appliance.

3. PART NAME

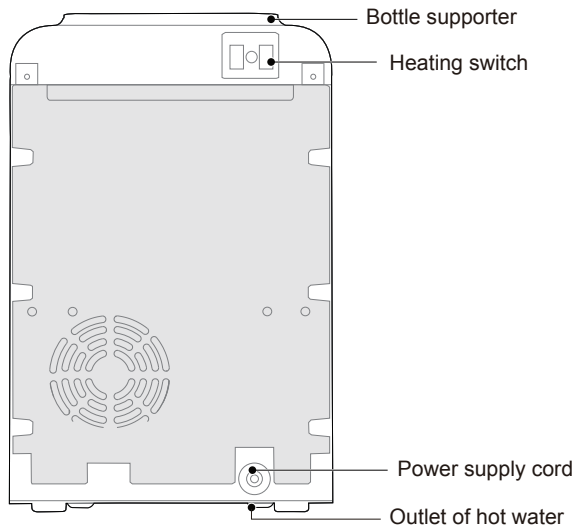
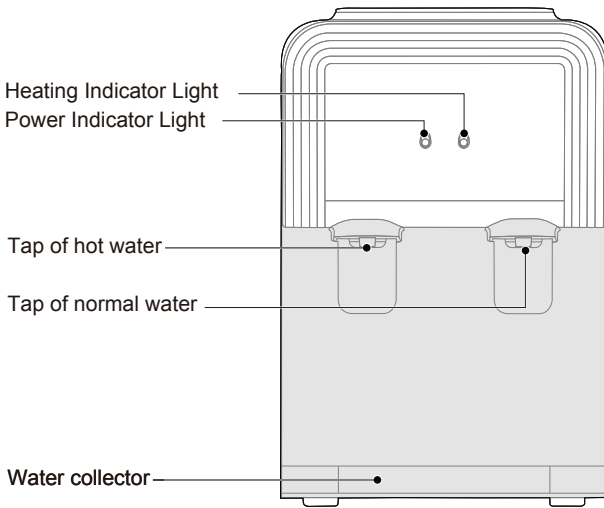

NOTE:

This machine can be suitable for bottle of 3 or 5 gallons, Don't use unhealthy hard water.

4. GETTING STARTED

1. Tear the label from the bottle.
2. Vertically insert the bottle into the bottle supporter on top of the machine. Do not plug the power cord or push the heating switch until water runs out from the tap of hot water.
3. Insert the plug to socket, then turn on the power switch. Indicators light up accordingly once the machine works.
4. Vertically pull out the bottle by two hands when the bottle is empty, then replace it with another bottle of water.
5. This appliance should work under environment of temperature from 10°C-43 °C humidity ≤ 90%.
6. This appliance is not suitable for installation in an area where a water jet could be used.

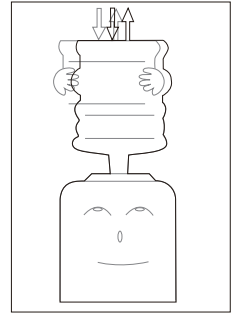

5. CAUTION

1. Keep this machine in a dry place and avoid direct sunlight. Rear of the machine should be at least 25cm away from the wall. Never put the machine on paper or foam, which may cause unstable surface, Never put anything flammable beside this machine.
2. To avoid damage to the machine, don't plug the power cord or turn on the heating switch until water runs out from the tap of hot water.
3. In case hot water is not needed for a long time, turn the switch accordingly to save power.
4. In case when not using this machine for a long time, turn off the switches, then pull the plug out from socket and drain the remaining water through draining outlet.

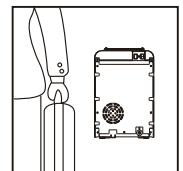
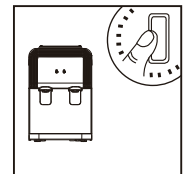
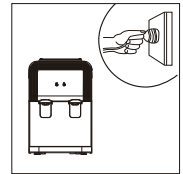
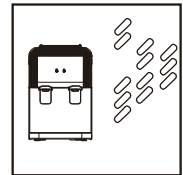

5. Never use organic liquid to clean the machine. Strictly prohibit splashing water on the unit.



6. Never turn on(off) the machine by plugging the plug to (pulling the plug out from) the socket. Never increase the length of the power supply cord to avoid fire.

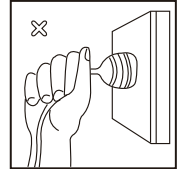

7. If the power cord is damaged, it must be replaced by the manufacturer, its service agent or similarly qualified persons in order to avoid a hazard. The machine should be plugged into the ground fault circuit breaker socket.

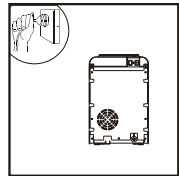

6. TROUBLE SHOOTING

Please check the followings before having the machine repaired.

Problem	Possible reason	Solution
No hot water	<ul style="list-style-type: none">Over consumption of hot water in short time.	Just wait a moment, then hot water is available again.
	<ul style="list-style-type: none">No power supply.	Connect plug to socket, turn on heating switch.
No water running out from taps	<ul style="list-style-type: none">Empty bottle.	Replace it with another one.
	<ul style="list-style-type: none">Inlet of bottle supporter. blocked by bottle seal.	Clean out wasted paper&bottle seal, install bottle again.
Leakage from bottle supporter	<ul style="list-style-type: none">Broken bottle.	Replace it with a new bottle.
Noisy operation	<ul style="list-style-type: none">Not placid installation.	Place the machine on placid & solid surface.

7. CLEANING

To avoid accident, cut off the power supply before operation according to the following instructions.

1. The machine had been disinfected before departing from factory. Clean the dispenser prior to installing a full bottle of water for the first time.

2. Cleaning and draining instruction:

- 1) Before cleaning, make sure the power switch in the O(off) position and unplug the water dispenser.
- 2) Vertically insert the bottle into the supporter on tap of the machine.
- 3) Open the taps, let about 3 liter water flow into a container.
- 4) Remove the water bottle from the dispenser.
- 5) Place a large bucket beneath the drain outlet. Remove the drain cover and allow water to drain.
- 6) After draining, replace the drain cover and you can use the machine.

Attention: The dispenser heats water to a temperature of approximately 85 °C. It can cause severe burns. Please operate it carefully.

3. Sanitizing

The machine should be disinfected with a disinfectant according to the instruction manual of the disinfectant and then clean it with water(see cleaning and draining instruction) Generally this should be done every three months.

4. To Remove Mineral Deposits:

Mix 4 liters water with 200g citric acid crystals, inject into the machine and make sure the water can flow out of the hot water tap. Switch on the power and heat it about 10 minute. 30 minutes later, drain off the liquid and clean it with water two or three times. Generally this should be done every six months.

Never disassemble this machine by yourself to avoid danger from damaging machine.

8. MACHINE INSTALLATION

Instructions for installation:

1-2. Screw onto the lower middle hole.

3. Fix the machine on the ground or the table.

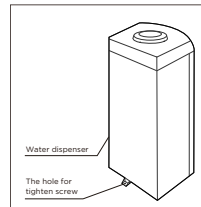
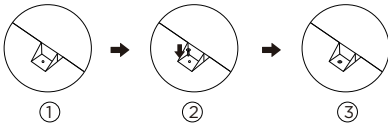

WARNING! To avoid a hazard due to instability of the appliance, it must be fixed in accordance with the instructions.

A Quality Product Of



The packaging material used is recyclable; we recommend that you separate plastic, paper and cardboard and give them to recycling companies. According to WEEE (Waste of Electrical and Electronic Equipment) guidelines, waste from electrical and electronic devices should be collected separately. If you need to dispose of this appliance in the future, do NOT throw it away with the rest of your domestic garbage. Instead, please take the appliance to the nearest WEEE collection point, where available.