

KEY FEATURES OF AIR COOLER

• STURDY DESIGN

Air coolers are designed to have excellent aesthetics & are made of sturdy thermoplastic material having excellent finish & corrosion free life.

• COLLAPSIBLE LOUVERS

Prevents dust and insects from entering air cooler while it is not in use.

• SPECIAL HONEYCOMB PADS

These are specially designed for Air cooler, made up of Antifungus environmental friendly cellulose based paper. The construction of the same is such that, it gives maximum contact surface with air & water. Which ensures efficient evaporation of water & gives better cooling effect.

Minimum two-three drain cycles to be carried out on purchase of the air cooler to eliminate smell of Honeycomb pads.

• WATER LEVEL INDICATOR

An easy to view water level transparent lens provided on the tank at front face, lets you keep a check on the water level in the tank.

• TOUGH & ELEGANT DUAL FAN

Specially designed for optimum efficiency having blades of non-corrosive material with three speed option.

• FREE WHEELING CASTORS

The cooler is mounted on castors which makes it convenient to wheel around from one place to another, even a child can move it around.

• DUST FILTER NET

A polymetric filter net at air inlet filters out the irritants & pollutants which are normally carried in the air & lets clean fresh air into the cooler.

A Quality Product Of

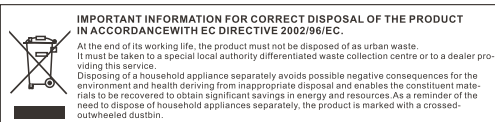

Visit us at: www.cginspiringlife.com

CG MERIDIA
SIGNATURE SERIES



Air Cooler INSTRUCTION MANUAL

Read this manual carefully before operation
Pictures in this manual are for reference only, the product in kind prevail.



MODEL : DOUBLE DECK 90

This instruction manual contains important information & recommendations that we would ask you to comply with to obtain best results from your products.



KNOW YOUR CG AIR COOLER

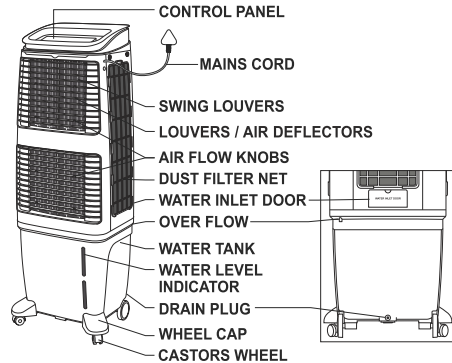

TECHNICAL SPECIFICATIONS

DESCRIPTION	DOUBLE DECK 90
VOLTAGE	220-240V / 50Hz AC
POWER CONSUMPTION	320 watt
SPEED LEVELS	THREE
AIR DEFLECTION	FOUR WAY
WATER TANK CAPACITY	90 liter
COOLING MEDIA	HONEY COMB
AIR DELIVERY	6000m ³ / Hr.
DIMENSIONS (L x W x H) cm	57.0 x 46.0 x 150.0
WEIGHT W/O WATER	18.8 kg

SAFETY : Earthing is provided. (In select models only)

MADE IN INDIA

INSTALLATION

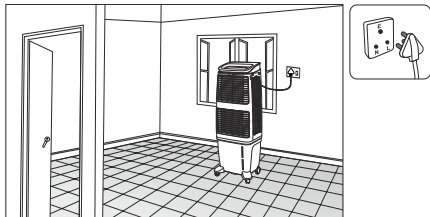

- 1) Place your Air Cooler at least 10 cm away from wall or any other obstruction. The Cooler should be placed near a window / door to allow in fresh air. The Cooler has been provided with inbuilt wheels for easy maneuverability.

- 2) Always ensure that there is another open window / door through which warm air can exhaust from the room. Constant air change is very essential for fresh air cooling by your Air cooler.
- 3) Plug in the mains cord of your Cooler to a wall socket. Ensure the supply of socket should be in OFF Position while plugging.
- 4) While plug in the mains cord please ensure that phase (L) & neutral (N) of the mains cord should match with the phase and neutral of the socket as per standard.

GETTING STARTED

- 1) Install the Cooler as per Installation procedure.

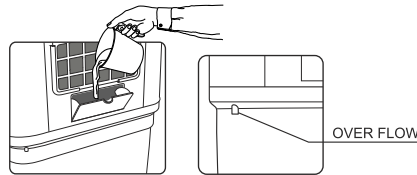

- 2) **FILLING OF WATER** : Just fill water tank (as per tank capacity) of your air cooler through the water inlet port. The water level indicator will Show when the tank is full. It is advisable to use tumbler to fill the water to ensure no spillage. (Ensure the power point is OFF while filling water) If filled water exceeds the tank capacity water will spill out from over flow spout.
- 3) **POWER SUPPLY** : Ensure that your Air cooler is plugged into specified Voltage & Frequency outlet and Switch 'ON' the power supply.
- 4) **PRE SOAKING** : Before putting on the Cooler fan, it is advisable to run pump for few minutes by rotating FUNCTION KNOB, This will ensure uniform Soaking of cooling media & avoid sprinkling of water if any.
- 5) **BETTER PERFORMANCE** : **For better air blast run the cooler on high speed. Run the cooler on low speed to get better cooling & low noise level.**
- 6) **CONTROLS** :
A) TOP FAN SPEED & BOTTOM FAN SPEED :
Controls the Top & Bottom fan speeds.
1) **OFF** : Cooler ON/OFF and Controls the fan speed.
2) **HIGH** : To get high speed of fan, keep the speed knob at "HIGH" position.
3) **MEDIUM** : To get Medium speed of fan, keep the speed knob at "MEDIUM" position.
4) **LOW** : To get low speed of fan, keep the speed knob at "LOW" position.

B) SWING : Controls the Swing movement of Air.

Controls the Top side & Bottom side horizontal oscillation of air, if air required only in particular direction then Off the "SWING" knob after getting required direction.

- 1) **OFF** : Swing movement ON/OFF and Controls Swing movement of Cooler.
- 2) **TOP** : To get Swing movement at Top side, keep the Swing knob at "TOP" position.
- 3) **BOTH** : To get Swing movement at Top & Bottom both side, keep the Swing knob at "BOTH" position.
- 4) **BOTTOM** : To get Swing movement at Bottom side, keep the Swing knob at "BOTTOM" position.

C) COOL : Controls the Cooling of Air.

To get cool air from unit, keep the cooling knob at "ON" position. In this mode water pump will ON. If cool air not required, keep the cooling knob at "OFF" position. In this mode water pump will OFF.

SAFETY PRECAUTIONS

- Always disconnect mains supply before filling water. • Do not fill the water, after overflow. • Do not try to fill the water into the cooler when in operation.
- Do not move the cooler rapidly when there is water in the tank. • Always disconnect mains before opening filter net or panels.
- Be particular & careful when using the cooler near curtains. Keep safe distance from the curtains. • Children must not be allowed to operate / play with cooler.

TROUBLE SHOOTING

If Air cooler fails to operate, please check the following before calling for service.

- Please check that there is electric supply at the power point. • Please check that the power point is switched 'ON' and that the plug is in its place correctly. • Please check that the controls are set properly.

OPERATIONAL CARE AND REGULAR MAINTENANCE

OPERATIONAL CARE :

- 1) When your Air Cooler is not in operation, make sure to switch all the switches to OFF Position.
- 2) Operate the buttons gently.
- 3) Do not wipe the cooler with harsh chemicals, scrubbing powder or thinner as they will damage the body.
- 4) Do not keep heavy load on the top of your Air Cooler.
- 5) Do not add any bleaching agents into the water in the tank.
- 6) Before moving or relocating the cooler ensure that the mains cord is unplugged and that the water tank is empty.
- 7) Do not immerse the unit in water.
- 8) Do not use any cleaning chemicals such as detergents and abrasives.

REGULAR MAINTENANCE :

Periodic maintenance helps to keep your Air Cooler in good condition.

- 1) It is recommended to drain the Cooler and clean the cooling pads every month.
- 2) Replace the HONEYCOMB PAD once in two / three years.
- 3) After the summer season ensure that the water is drained off completely & pads are dried before storage.

CLEANING OF COOLER BY DRAINING WATER :

Pull to remove the drain plug given to the water tank to drain the remaining water from the tank. After draining, push to fix drain plug properly. For better performance & longer life of pads, it is advisable to drain water on regular basis.

