

## KEY FEATURES OF AIR COOLER

### • STURDY DESIGN

Air coolers are designed to have excellent aesthetics & are made of sturdy thermoplastic material having excellent finish & corrosion free life.

### • SPECIAL HONEYCOMB PADS

These are specially designed for Air cooler, made up of Antifungus environmental friendly cellulose based paper. The construction of the same is such that, it gives maximum contact surface with air & water. Which ensures efficient evaporation of water & gives better cooling effect.

**Minimum two-three drain cycles to be carried out on purchase of the air cooler to eliminate smell of Honeycomb pads.**

### • SPECIAL WOOD WOOL PADS ( In select models only)

Himalayan pine wood wool provided for odorless & fresh cool air. The unique construction of these pads gives maximum contact surface with air & water. This ensures efficient evaporation of water & giving very effective cooling.

### • WATER LEVEL INDICATOR

An easy to view water level transparent lens provided on the tank at front face, lets you keep a check on the water level in the tank.

### • TOUGH & ELEGANT FAN

Specially designed for optimum efficiency having blades of non-corrosive material with three speed option.

### • FREE WHEELING CASTORS

The cooler is mounted on castors which makes it convenient to wheel around from one place to another, even a child can move it around.

A Quality Product  
Of

**CG CHAUDHARY GROUP**  
*Touching life everyday*



**IMPORTANT INFORMATION FOR CORRECT DISPOSAL OF THE PRODUCT IN ACCORDANCE WITH EC DIRECTIVE 2002/96/EC.**  
At the end of its working life, the product must not be disposed of as urban waste. It must be taken to a special local authority differentiated waste collection centre or to a dealer providing this service.  
Disposing of a household appliance separately avoids possible negative consequences for the environment and health deriving from inappropriate disposal and enables the constituent materials to be recovered to obtain significant savings in energy and resources. As a reminder of the need to dispose of household appliances separately, the product is marked with a crossed-out wheeled dustbin.

Visit us at: [www.cginspiringlife.com](http://www.cginspiringlife.com)

5

1  
NEPAL'S  
No. 1  
BRAND

**CG**  
inspiring Life  
SINCE 1982

## AIR COOLER INSTRUCTION MANUAL

Read this manual carefully before operation  
Pictures in this manual are for reference only, the product in kind prevail.

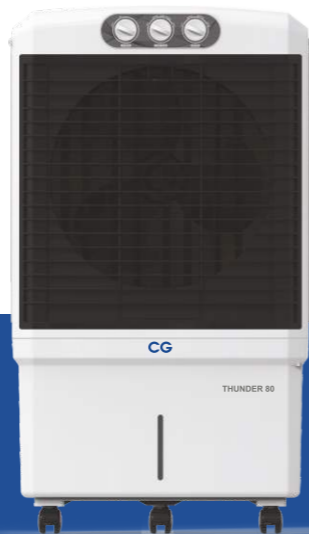

### MODEL : THUNDER 80

This instruction manual contains important information & recommendations that we would ask you to comply with to obtain best results from your products.

**CG CHAUDHARY GROUP**  
*Touching life everyday*

6

## KNOW YOUR CG AIR COOLER

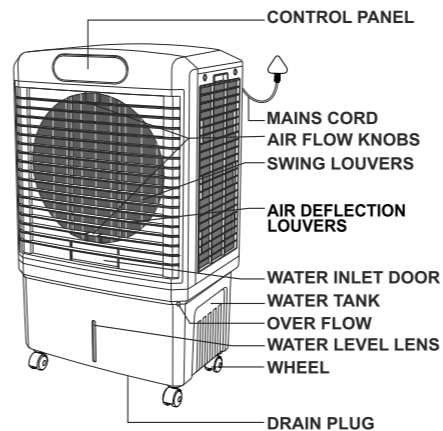

## TECHNICAL SPECIFICATIONS

DESCRIPTION	THUNDER 80
VOLTAGE	220-240V, 50Hz AC
POWER CONSUMPTION	175 watt
SPEED LEVELS	THREE
AIR DEFLECTION	FOUR WAY
WATER TANK CAPACITY	80 liter
COOLING MEDIA	WOOD WOOL HONEY COMB
AIR DELIVERY	WOOD WOOL 3800m <sup>3</sup> / Hr. HONEY COMB 4000m <sup>3</sup> / Hr.
DIMENSIONS (L x W x H) cm	65.0 x 51.0 x 114.0
WEIGHT W/O WATER	16.5 kg

SAFETY : Earthing is provided. (In select models only)

MADE IN INDIA

2

## INSTALLATION

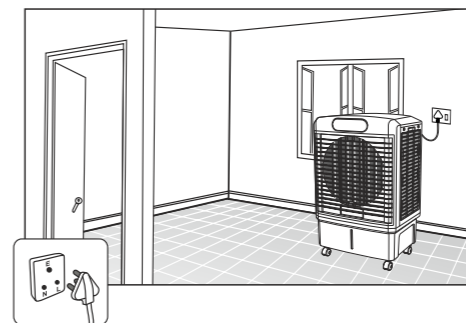

- Place your Air Cooler at least 10 cm away from wall or any other obstruction. The Cooler should be placed near a window / door to allow in fresh air.
- Always ensure that there is another open window / door through which warm air can exhaust from the room. Constant air change is very essential for fresh air cooling by your Air cooler.
- Plug in the mains cord of your Cooler to a wall socket. Ensure the supply of socket should be in OFF Position while plugging.
- While plug in the mains cord please ensure that phase (L) & neutral (N) of the mains cord should match with the phase and neutral of the socket as per standard.

## GETTING STARTED

- Install the Cooler as per Installation procedure.



- FILLING OF WATER :** Just fill water tank (as per tank capacity) of your air cooler through the water inlet port. The water level will be viewed through lens. It is advisable to use tumbler to fill the water to ensure no spillage. (Ensure the power point is OFF while filling water). If filled water exceeds the tank capacity water will spill out from over flow spout.
- POWER SUPPLY:** Ensure that your Air cooler is plugged into specified Voltage & Frequency outlet and Switch 'ON' the power supply.
- PRE SOAKING :** Before putting on the Cooler fan, it is advisable to run pump for few minutes by rotating FUNCTION KNOB, This will ensure uniform Soaking of cooling media & avoid sprinkling of water if any.

- BETTER PERFORMANCE :** For better air blast run the cooler on high speed. Run the cooler on low speed to get better cooling & low noise level.

### 6) CONTROLS :

- Set the POWER Knob to ON position. Set the SPEED Knob to desired level viz. WINDY, GENTLE, QUIET (i.e. high, medium, low,) of air delivery. If you want to use the cooler in COOL mode; Set the FUNCTION Knob to COOL / SWING position to obtain continuous horizontal oscillation of air.
- If you need a focused blast of cool air, wait for the blast to focus in the direction you desire and then turn the FUNCTION Knob to COOL Position.
- When you want to use the cooler in FAN mode; set the FUNCTION Knob to SWING position to obtain continuous horizontal oscillation of air. If you need to focused blast of fresh air, wait for the blast to focus in the direction you desire and then turn the FUNCTION Knob to OFF Position.
- AIR FLOW KNOB directs the flow of air UP/DOWN.

## SAFETY PRECAUTIONS

- Always disconnect mains supply before filling water. Do not fill the water, after overflow. Do not try to fill the water into the cooler when in operation.
- Do not move the cooler rapidly when there is water in the tank. Always disconnect mains before opening filter net or panels.
- Be particular & careful when using the cooler near curtains. Keep safe distance from the curtains. Children must not be allowed to operate / play with cooler.

## TROUBLE SHOOTING

If Air cooler fails to operate, please check the following before calling for service.

- Please check that there is electric supply at the power point.
- Please check that the power point is switched 'ON' and that the plug is in its place correctly.
- Please check that the controls are set properly.

## OPERATIONAL CARE AND REGULAR MAINTENANCE

**OPERATIONAL CARE :** 1) When your Air Cooler is not in operation, make sure to switch all the switches to OFF Position. 2) Operate the buttons gently. 3) Do not wipe the cooler with harsh chemicals, scrubbing powder or thinner as they will damage the body. 4) Do not keep heavy load on the top of your Air Cooler. 5) Do not add any bleaching agents into the water in the tank. 6) Before moving or relocating the cooler ensure that the mains cord is unplugged and that the water tank is empty. 7) Do not immerse the unit in water. 8) Do not use any cleaning chemicals such as detergents and abrasives. 9) Do not allow the interior (special for the PCB) to get wet as this could create a hazard.

**REGULAR MAINTENANCE :** Periodic maintenance helps to keep your Air Cooler in good condition. 1) It is recommended to drain the Cooler and clean the cooling pads every month. 2) Replace the HONEYCOMB PAD once in two / three years & replace the cooler pad once a year in case of WOOD WOOL. 3) After the summer season ensure that the water is drained off completely & pads are dried before storage.

### CLEANING OF COOLER BY DRAINING WATER :

Pull to remove the drain plug given to the water tank to drain the remaining water from the tank. After draining, push to fix drain plug properly. For better performance & longer life of pads, it is advisable to drain water on regular basis.

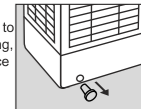

3