

# BLDC CEILING FAN INSTRUCTION MANUAL

Read this manual carefully before operation

Pictures in this manual are for reference only, the product in kind prevail.



## Model:

**CGMRCF48DC ROYAL BLUE**

**CGMRCF48DC TOPAZ GOLD**

**CGMRCF48DC MATT BRONZE**

**CGMRCF48DC WHITE**

**This instruction manual contains important information  
& recommendations that we would ask you to comply  
with to obtain best results form your products.**

# INSTRUCTION MANUAL

## SAFETY INSTRUCTIONS

- Ensure that the supply is AC and the Voltage is as per the specification printed on the name plate.
- User should use minimum 1.0 Sq mm cable wire for electric connection.
- There are no consumer serviceable parts inside this fan. Do not attempt to open/ repair the fan on your own, doing so could cause damage to the fan and/or lead to personal injury.
- User terminal blocks to connect wires and not just tape.
- Ensure that the height of the fan from the ground should be more than 2.3m when it is installed.
- This appliance is not intended for use by person (including children) with reduced physical, sensory or mental capabilities, or lack of experience and knowledge, unless they have been given supervision or instruction concerning use of the appliance by a person responsible for their safety.
- Children should be supervised to ensure that they do not play with the appliance.
- **WARNING:** If unusual oscillating movement is observed, immediately stop using the ceiling fan and contact the manufacturer, its service agent or suitably qualified persons.
- The replacement of parts of the safety suspension system device shall be performed by the manufacturer, its service agent or suitably qualified persons.
- The mounting of the suspension system shall be performed by the manufacturer, its service agent or suitably qualified persons.

## INSTALLATION INSTRUCTIONS

- Weight of fan is approx. 3-5kg
- The fixing means for attachment to the ceiling such as hook or other devices shall be fixed with a sufficient strength to withstand 4 times the weight of the ceiling fan.

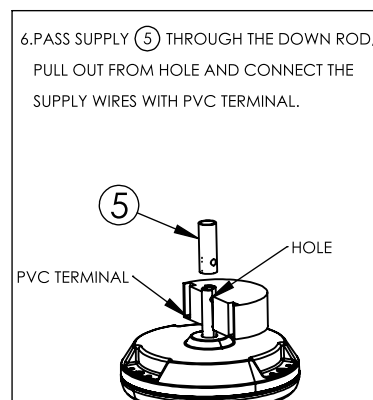
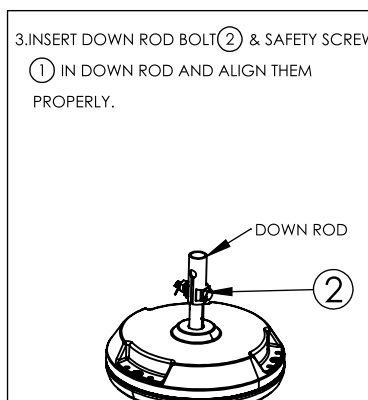
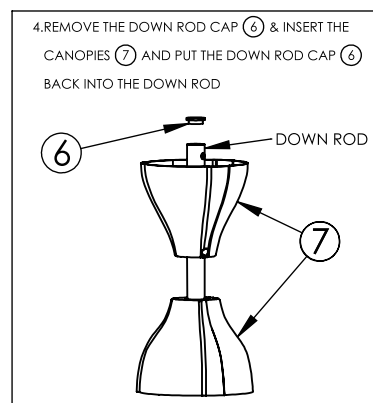
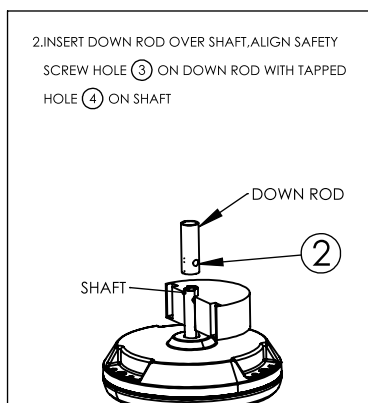
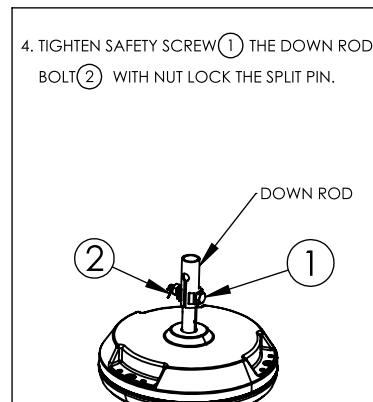
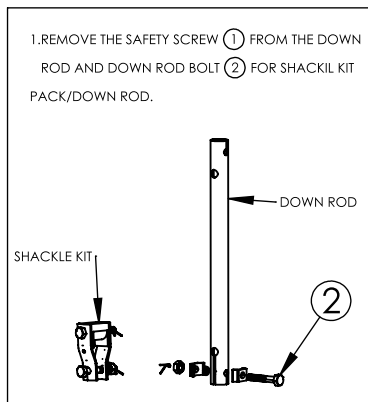

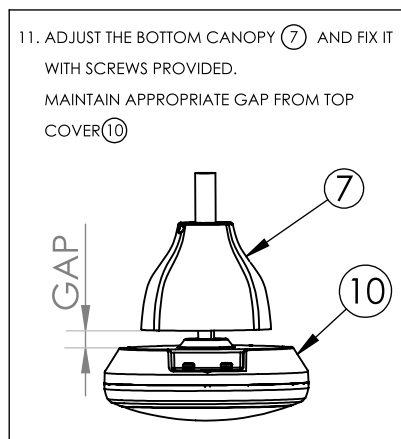
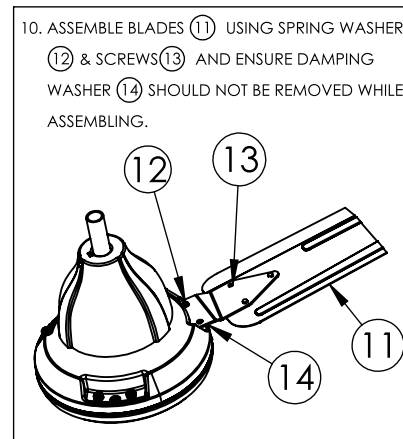
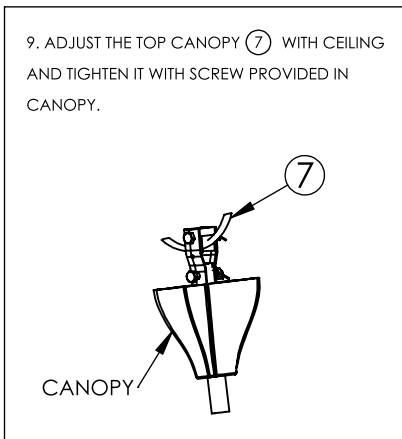
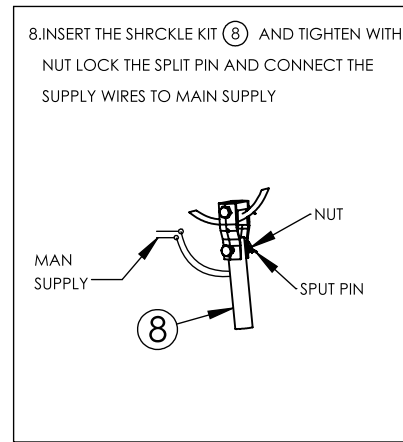
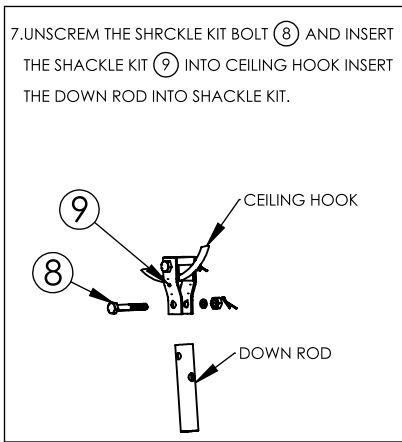

## CAUTION

- Never open or try to loose on the base plate.

## CLEANING/MAINTENANCE INSTRUCTIONS

- To clean the fan, wipe it with a soft and clean cloth.
- Do not apply pressure on the blade in order to prevent them from bending.
- If servicing, refer only to a qualified electrician.
- For oiling use ALFA ZN 320 oil and greasing use SHELL RL3 grease.

**FUNCTIONS OF REMOTE:**



**WARNING**

DO NOT use the fan regulator as the fan is operated using a remote.  
Eliminate the regulator by using a direct connection from the switch to the fan.

S.no	Remote Key	Function	Description
1	Power	On	Switches ON the fan.
2	Power	OFF	Switches OFF the fan.
3	1-5	Fan Speed Control	Change of speed from low to high or Vice Versa.
4	Boost	Boost Mode	Boost Mode Speed On.
5	Reverse	Reverse Mode on	Fan Run in reverse direction, only 1-3 speed will work in reverse direction. Reverse button press twice, it will disable reverse mode and Fan will run in forward direction from same position as it was in reverse direction.
6	Smart	Reduce Speed of fan by 1	When Smart key is press, Smart mode enabled and Speed of Fan reduce by 1 every 2hr and will run on 1 <sup>st</sup> speed continuously at last. Smart Mode Button press twice, It will disable smart mode.
7	Timer	Off timer/Wake Up Timer	Fan Automatically Switches on/off after set hours(2,4,6,8Hrs) Timer Button Press twice, It will disable Timer mode

## TROUBLE SHOOTING:

Warning: The power must be switched OFF prior to commencing troubleshooting procedures.

TROUBLE	PROBABLE CAUSES	SUGGESTED REMEDY
1.Fan is not operating or not operating correctly	Mains power not connected.	<ul style="list-style-type: none"> <li>- Replace fuse or reset circuit breaker.</li> <li>- Turn ON isolation switch.</li> </ul>
	Loose wire connection to fan or to the switch on the panel	<ul style="list-style-type: none"> <li>- Check the wire connection and restore the Connection</li> </ul>
	Regulator is connected to the fan	<ul style="list-style-type: none"> <li>- It is recommended that the regulator should not be connected to this ceiling fan and it is instead controlled using the remote provided with it.</li> </ul>
	Fan not pair with remote	<ul style="list-style-type: none"> <li>- After power switch ON than put continuous press on/off button of remote within 4 Second, If remote is paired than long beep will be create</li> </ul>
	Fan still does not start	<ul style="list-style-type: none"> <li>- Please contact the service number provided</li> </ul>
2. Fan Making Noise	Bearing inside the housing has problem	<ul style="list-style-type: none"> <li>- This ceiling fan is designed to be long lasting. However, after many years of use the bearing noise has problems may wear off and may need to be replaced.</li> </ul>
	Canopy touching the fan body or Ceiling	<ul style="list-style-type: none"> <li>- Make sure that the canopy and the wire that connects the fan are not touching the body of the motor or Ceiling of house</li> </ul>
	Fan blades are not seated properly on body.	<ul style="list-style-type: none"> <li>- Make sure the blades are properly fastened to the body. Loose connection may cause accident.</li> </ul>
3.Fan is Wobbling	Nut holding the motor shaft and Down rod is loose	<ul style="list-style-type: none"> <li>- Securely fasten the nut and bolts along with washers.</li> </ul>
	Screws in Shackle kit and ceiling hook are loose	<ul style="list-style-type: none"> <li>- Securely fasten the nut and bolts along with washers.</li> </ul>
	Fan Blades are not seated properly on the motor	<ul style="list-style-type: none"> <li>- A common mistake is fixing the blade in the reverse direction, please set it rightly securely fasten the screws.</li> </ul>
	Fan blades are out of balance	<ul style="list-style-type: none"> <li>- Make sure blades are not bend during cleaning. Also interchanging them helps balance the blades.</li> </ul>
4. Remote not working	Battery is flat	<ul style="list-style-type: none"> <li>- Replace with all new batteries. Do not mix up the old and new battery.</li> </ul>
	Battery at wrong polarity	<ul style="list-style-type: none"> <li>- Reinstall the battery at right polarity</li> </ul>
	The contacts in battery compartment are corroded or bent.	<ul style="list-style-type: none"> <li>- Clean corroded contacts. Bend contacts backto their correct position.</li> </ul>

Warning: Some troubleshooting tasks can only to be performed by a qualified electrician .

**A Quality Product  
Of**



**IMPORTANT INFORMATION FOR CORRECT DISPOSAL OF THE PRODUCT  
IN ACCORDANCE WITH EC DIRECTIVE 2002/96/EC.**

At the end of its working life, the product must not be disposed of as urban waste. It must be taken to a special local authority differentiated waste collection centre or to a dealer providing this service.

Disposing of a household appliance separately avoids possible negative consequences for the environment and health deriving from inappropriate disposal and enables the constituent materials to be recovered to obtain significant savings in energy and resources. As a reminder of the need to dispose of household appliances separately, the product is marked with a crossed-out wheeled dustbin.

Visit us at: [www.meridia.cginspiringlife.com](http://www.meridia.cginspiringlife.com)